

HOW TO USE

1. Load all files attached in action's folder.

- Action File (.atn)
- Brushes File (.abr)
- Patterns File (.pat)
- Tools File (.tpl)



2. To load them easily , you can double click each file and it will be loaded successfully to Photoshop.

3. While you load **Tool File (.tpl)** , a small window will appear choose from it Load as Tools.

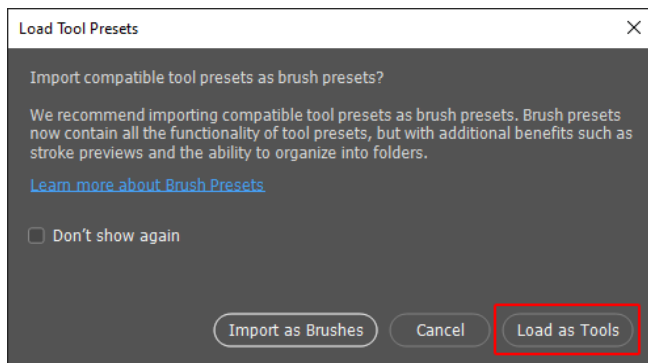

4. Open your photo and make sure its Larger than 1500 x 1500 pixels.

5. Play Action.

For further questions , Please contact me using contact form in this page:
<https://graphicriver.net/user/ihemalaya>