

INSTRUCTIONS



THE EASIEST WAY TO ADD AUTHENTIC TORN PAPER EDGES TO DESIGNS!

THANKS FOR PURCHASING 'RIP IT UP - TORN EDGE BRUSHES'!

PLEASE NOTE: This product is compatible with Procreate only. An Apple Pencil or other compatible stylus is required to use the brushes to their full potential.

Affinity Designer and Illustrator versions of the pack are also available at artifexforge.com.

Please see below for usage instructions.

UNZIPPING THE BRUSHES

Before you can load the brushes you must unzip the brush files. Follow these steps:

ON A COMPUTER (MAC):

1. Double-click the '.zip' file.
2. Locate the file or folder inside and move it to the location of your choice.

ON A COMPUTER (PC):

1. Right-click on the '.zip' file.
2. Click 'EXTRACT ALL' and follow the instructions.

IF YOU DON'T OWN A COMPUTER:

Depending on your OS you may need a third party plug in to decompress a zip file on Ipad.

LOADING THE BRUSHES INTO PROCREATE

Once you've unzipped the brush file please install it by following these steps:

1. Transfer the '.BRUSHSET' file/s from your computer to your Ipad. Using a cloud service such as 'DROPBOX'.
2. On your Ipad open the cloud service app and locate the folder into which you saved the '.BRUSHSET' file.
3. Tap the '.BRUSHSET' file and click the '...' icon.
4. Click 'EXPORT', 'OPEN IN...' and then tap 'COPY TO PROCREATE'.
5. Open Procreate. Your new brush set will appear at the top of the brush library.

Please note: if you have MacOS 10.11 or newer, you can use 'AIRDROP' to transfer and install the brushes in one go.

IMPORTANT: Don't use Procreate's brush panel import function - this is designed for single brushes only and won't work with '.BRUSHSET' files.

DRAWING WITH THE BRUSHES

To draw with the brushes simply select a brush from the ‘BRUSH LIBRARY’ and draw.

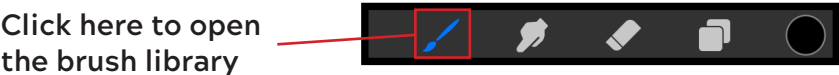

To adjust the size of the brush stroke move the slider as shown below:

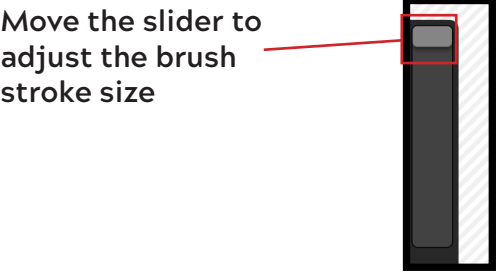

Choose the brush color by clicking in the circle on the right-hand, top of the screen, as circled below. Do this before you draw.

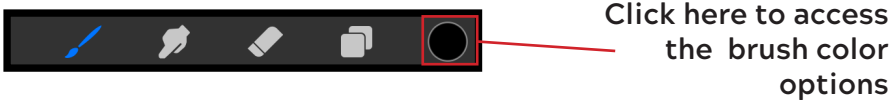

Using your Apple Pencil (or other compatible stylus) adjust the pressure as you draw to create a range of marks.

Draw with your finger to create even sized torn edges.

ADDING A DROP-SHADOW TO YOUR TORN EDGES

Adding a drop-shadow to your torn edge will give it more definition and will help to show off the texture.

1. Duplicate your ‘OUTLINE LAYER’ by dragging the relevant layer icon to the left then clicking ‘DUPLICATE’.

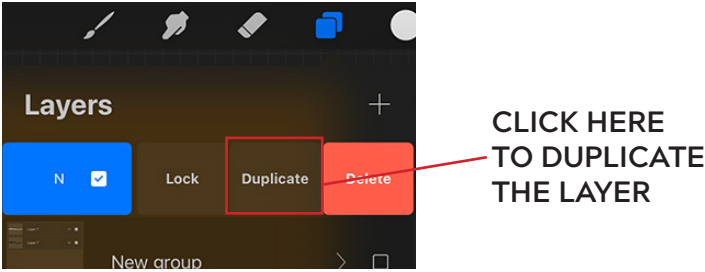

2. Select the lower copy of the torn edge layer and then Open the ‘ADJUSTMENTS’ menu by tapping on the icon shown below. Choose ‘HUE,SATURATION,BRIGHTNESS’, then ‘LAYER’.

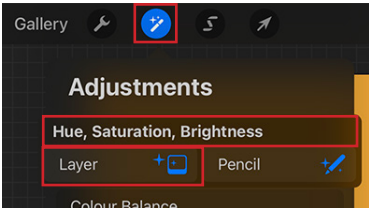

3. Slide the ‘BRIGHTNESS’ slider all the way to the left, as per the image below. Tap the ‘ADJUSTMENTS’ icon again, to confirm the change.

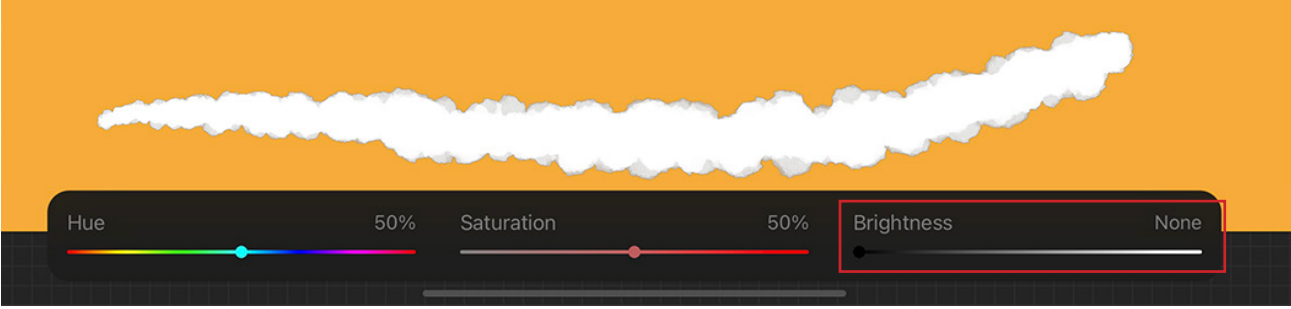

4. With the lower copy of the torn edge layer still selected, tap the ‘ADJUSTMENTS’ icon again. Then Choose ‘GAUSSIAN BLUR’ and ‘LAYER’.

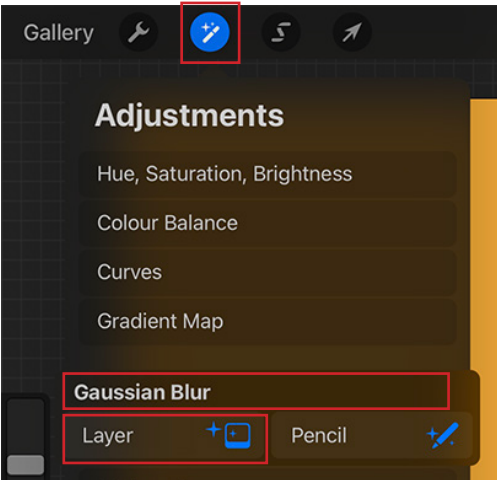

5. Slide to the right to increase the blur until you’re happy with it. How far you slide will depend on the size of your image and personal preference. I tend to keep drop shadows subtle. Tap the ‘ADJUSTMENTS’ icon again, to confirm the change.

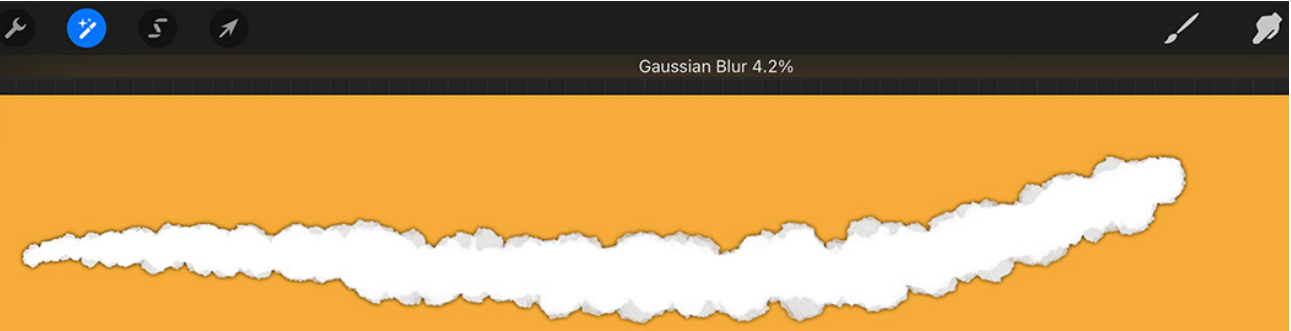

6. Click the 'N' on the shadow layer, then set the layer's blend mode to 'MULTIPLY' (the 'N' will change to an 'M') and adjust the 'OPACITY' (between 20 and 40% works best).

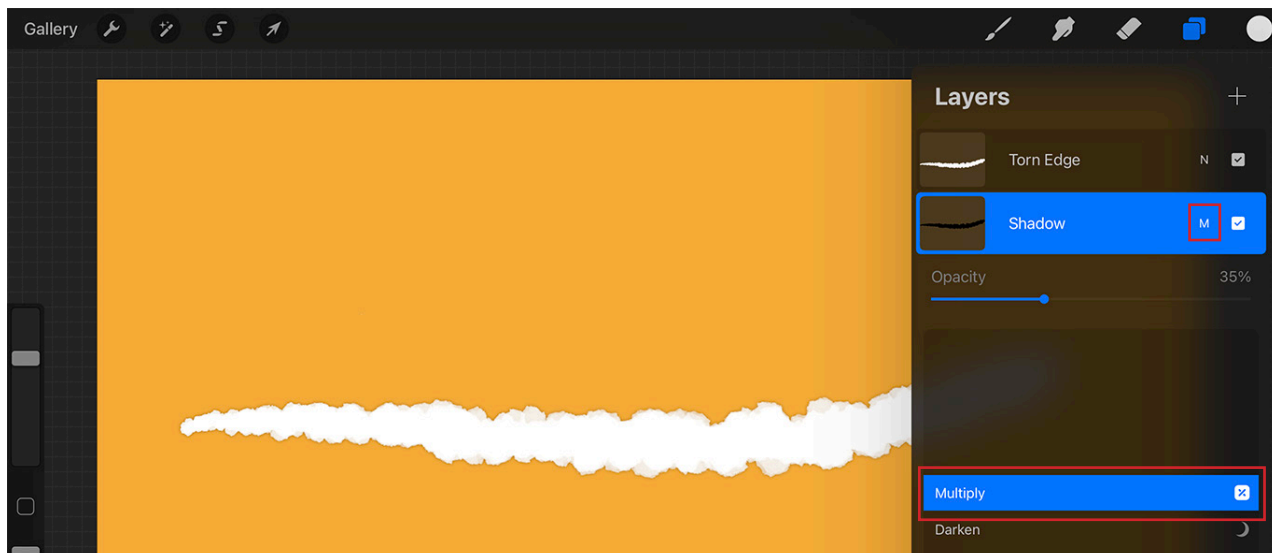

7. Move the shadow layer to match the lighting in your design.

GET IN TOUCH!

NEED HELP WITH THE PACK?

Please fill in my Product Support form [HERE](#) and I'll get back to you just as soon as I can.

Please contact me before leaving negative feedback. I will always do my best to get the product working for you.

Instagram



FOLLOW ME ON [INSTAGRAM](#)
TO SEE MY LATEST TOOLS FIRST

I'd love to see what you create, so why not send a screen-shot of your work?

Take a look at some of the amazing art made using Artifex Forge Products [HERE](#)

GET FREE PRODUCTS when you sign up to my mailing list [HERE](#)

