

Flyer Resume CV Print Templates

Very easy and quick to edit

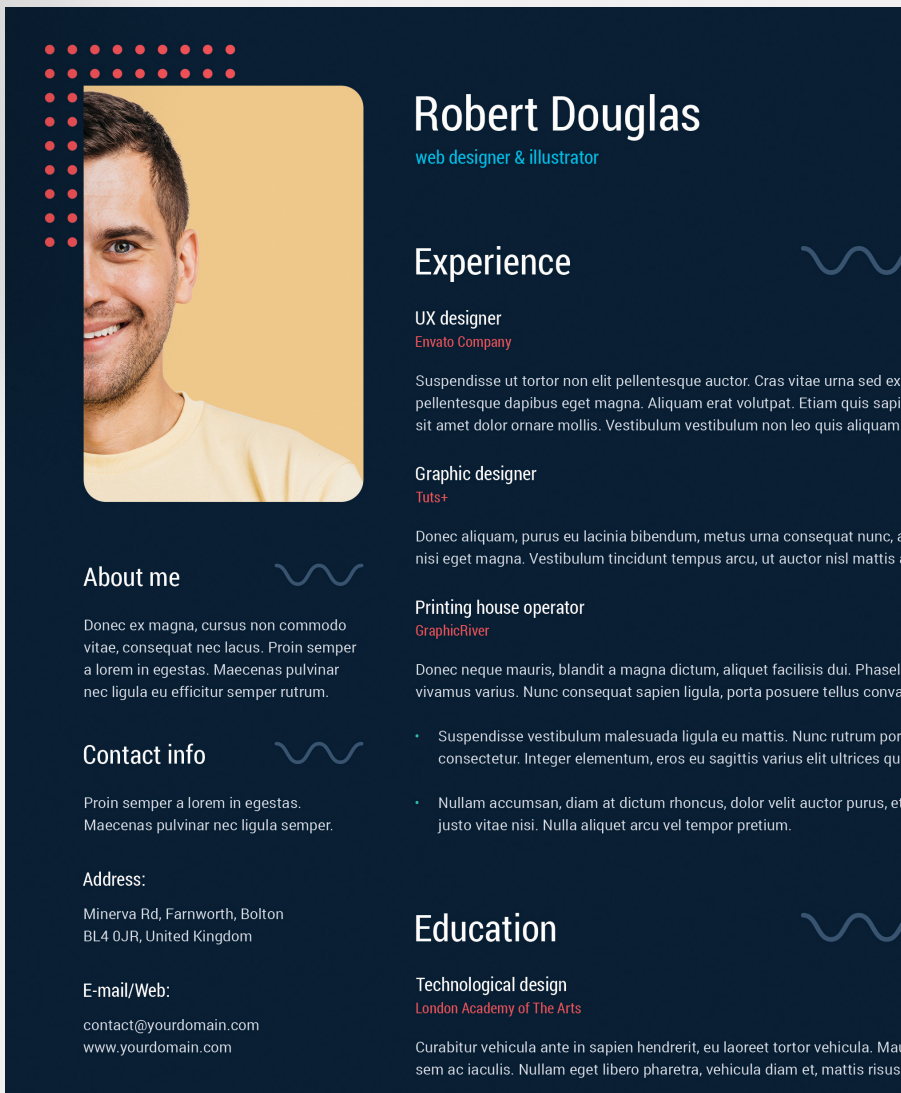
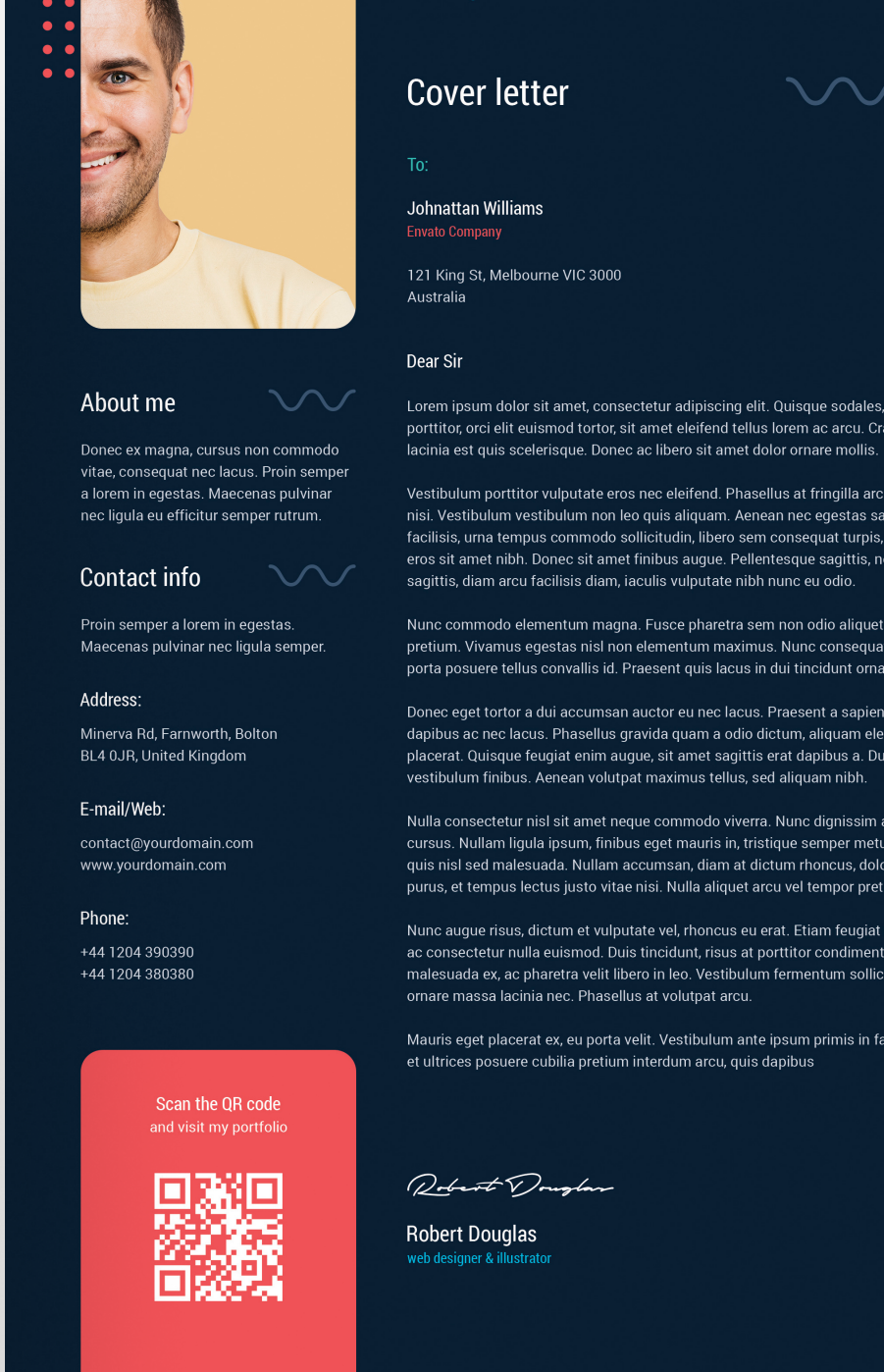
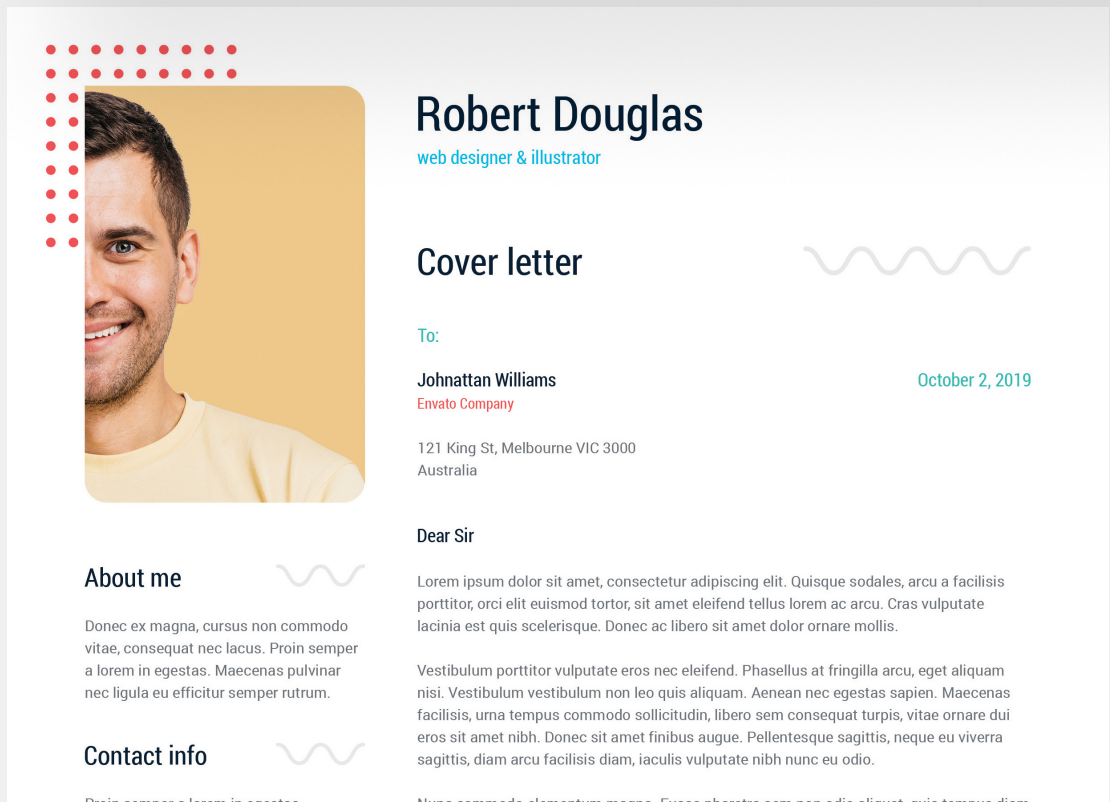
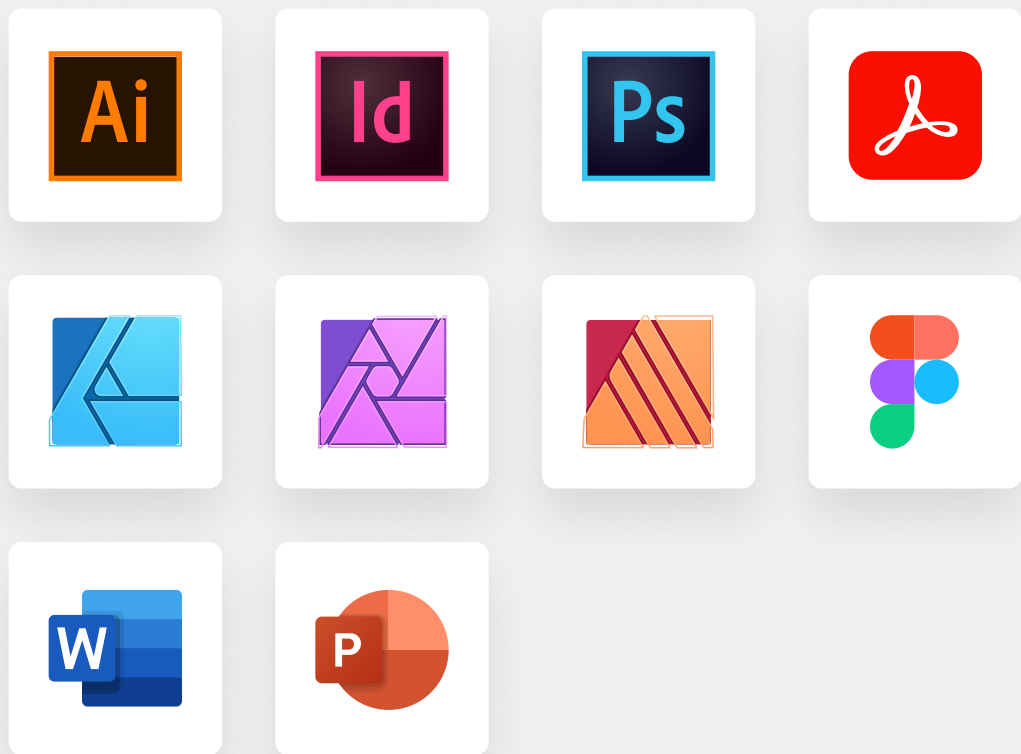

Aa

Google Fonts

Install fonts

Before starting work, **install the necessary fonts**. The fonts used are from **Google Fonts**.

Roboto Condensed

Roboto

The use of **Google Fonts** is very quick, easy and, above all, accessible to everyone. Install the fonts that are right for you and change the template to best suit you.

Figma software does not require the installation of additional fonts.

 Google Fonts

Roboto Condensed

Designed by [Christian Robertson](#)

[Select styles](#)

[Glyphs](#)

[About](#)

[License](#)

Styles

Type here to preview text

Almost before we knew it, we had left the ground.

Light 300

Almost before we knew it, we

Light 300 italic

Almost before we knew it, we

Regular 400

Almost before we knew it, w

Regular 400 italic

Almost before we knew it, we

Bold 700

Almost before we knew it, w



Adobe Illustrator

Change text

To edit the text, **double-click on the text field** you want to edit and type or paste the text that suits you.

Add your image

Select the gray rectangle that says "**your image here**". Then in the tool panel (on the left side of the screen) select "**drawing mode inside**" or **Shift + D**.

Select this option, then place the photo. Add a photo by selecting **File - Place**. The photo will be added. All you need to do is adjust it to the placeholder.

Color template

Select a color from the "Swatches" panel and change the color by double-clicking on any tile with the caption "**Color template ...**" or "**Title color**" / "**Text color**"

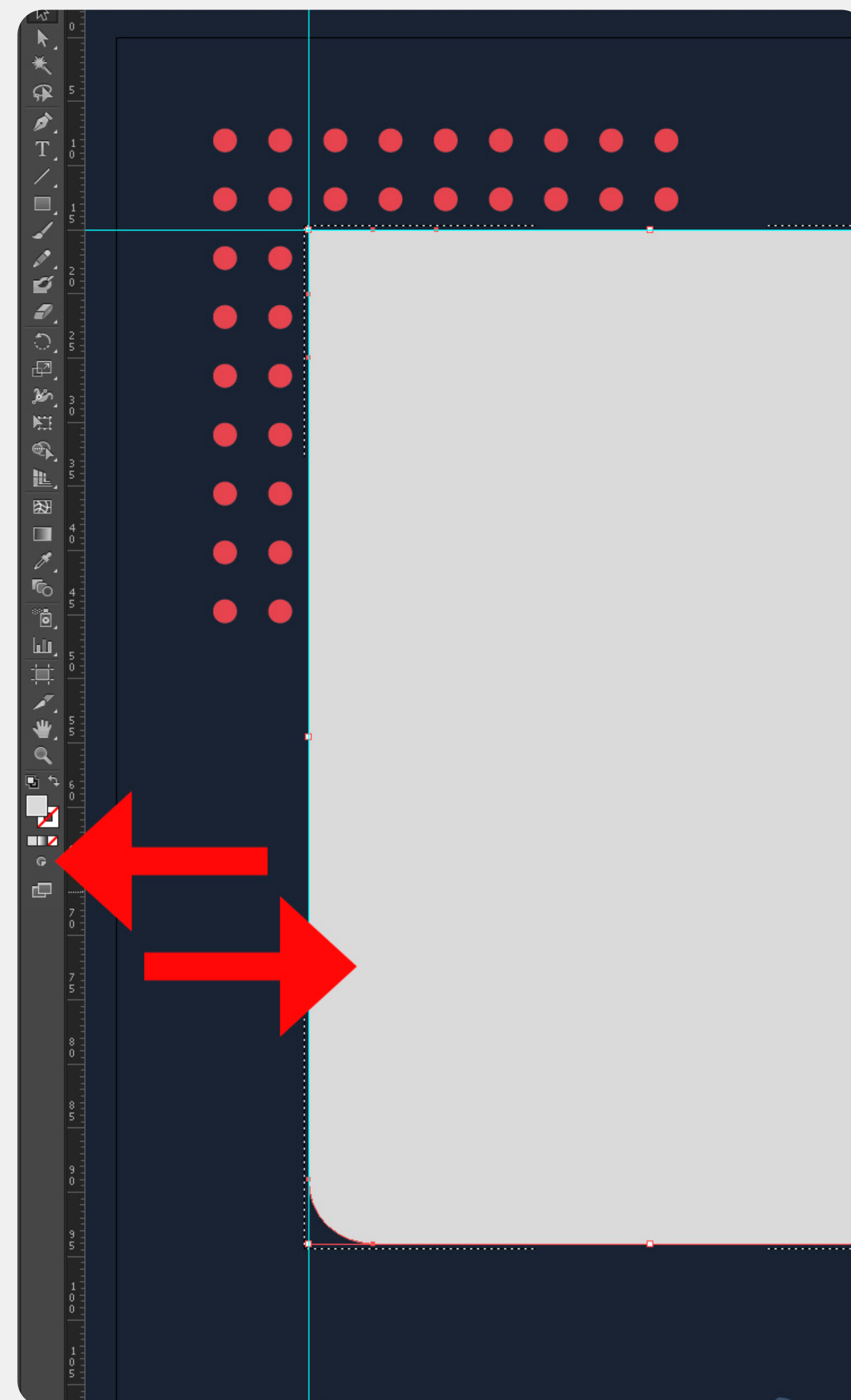



Adobe InDesign

Change text

To edit the text, **double-click on the text field** you want to edit and type or paste the text that suits you.

Add your image

Select the gray rectangle that says "**your image here**".
Drag the image into the rectangle or choose **File - Place (Ctrl + D)** and select your photo. Adjust the photo to the size of the rectangle.

Color template

Select a color from the "Swatches" panel and change the color by double-clicking on any tile with the caption "**Color template ...**" or "**Title color**" / "**Text color**"

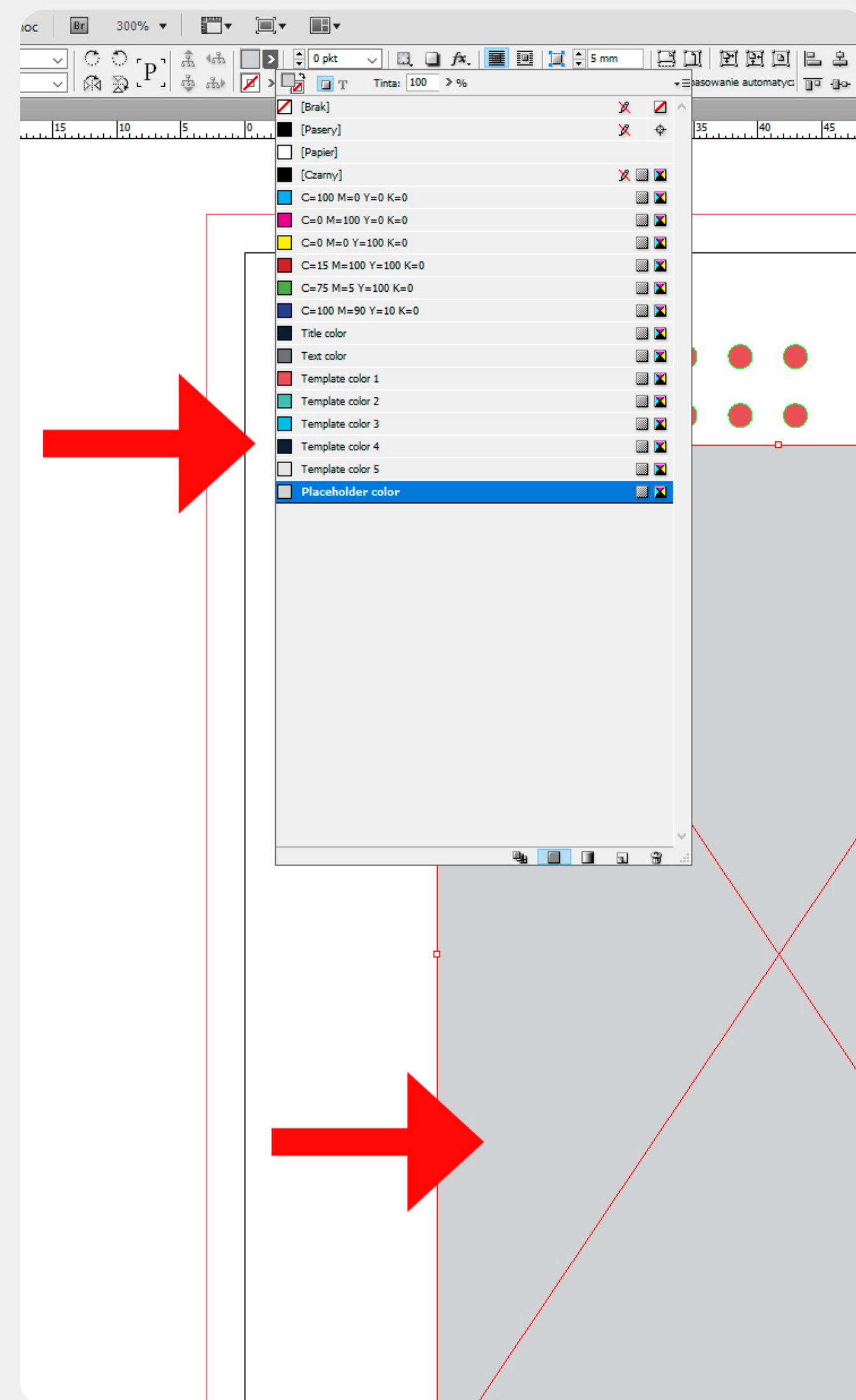

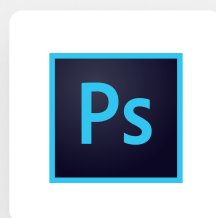

Adobe Photoshop

Change text

To edit the text, **double click on the layer with the text in the "Layers" panel** and type or paste the text that suits you.

Add your image

Double-click on the layer labeled "**your image here**" in the "**Layers**" panel. A new window will appear to which you must **drag the image**. Then confirm the changes with "**enter**" and save the file (**Ctrl + S**). Close the window and go back to the previous view.

Color template

Select the single item you want to change or select several similar items. For example, select section **titles by pressing Shift and clicking** the mouse on individual elements. From the "**color**" panel, select any that interests you.

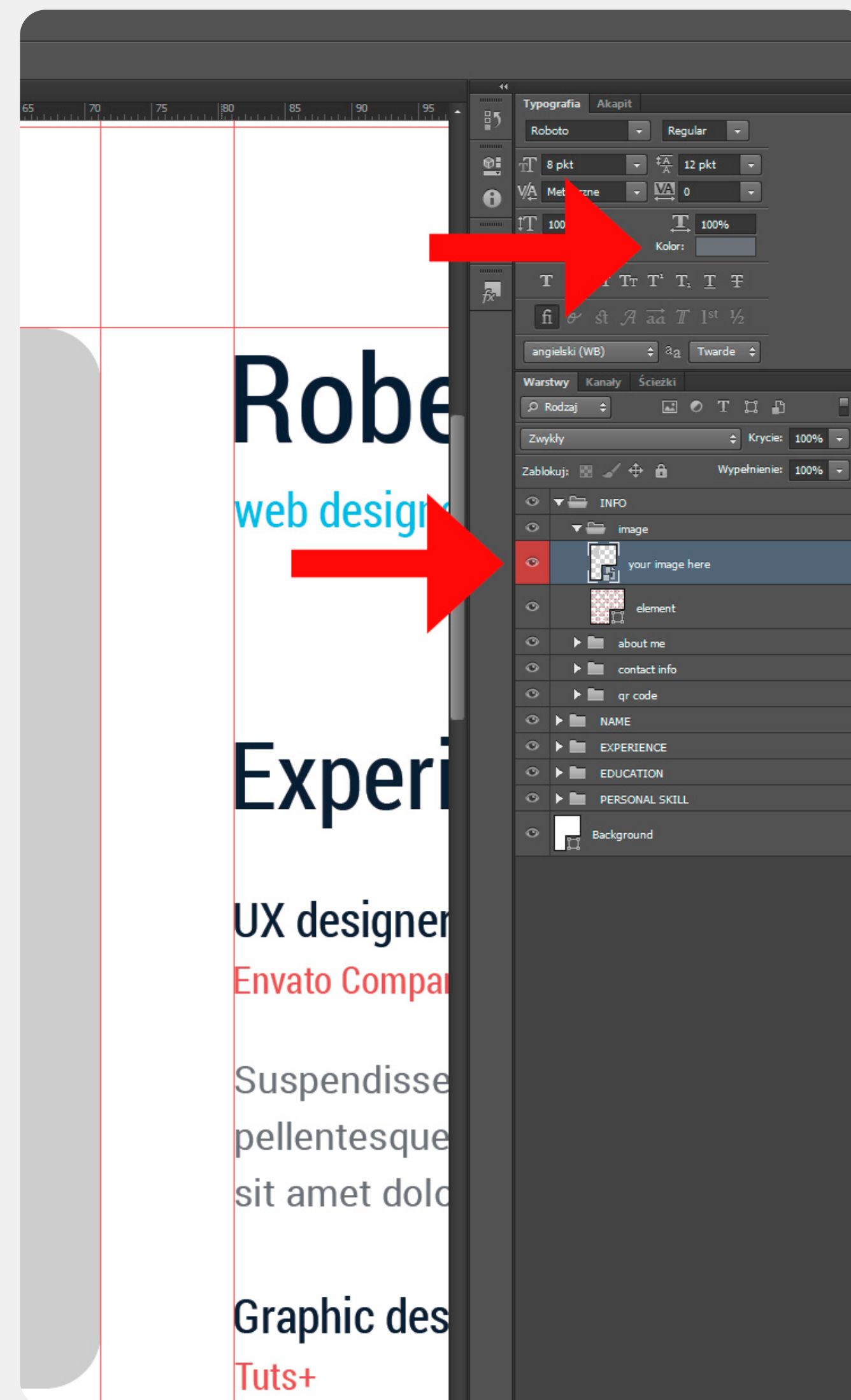



Affinity Designer

Change text

To edit the text, **double-click on the text field** you want to edit and type or paste the text that suits you.

Add your image

Select the gray rectangle that says "**your image here**".
Drag the image into the rectangle or choose **File - Place** and select your photo. Adjust the photo to the size of the rectangle.

Color template

In the "**Swatches**" tab, select the "**Document**" colors and then you can freely edit the entire layout by **clicking on a particular tile / color**.

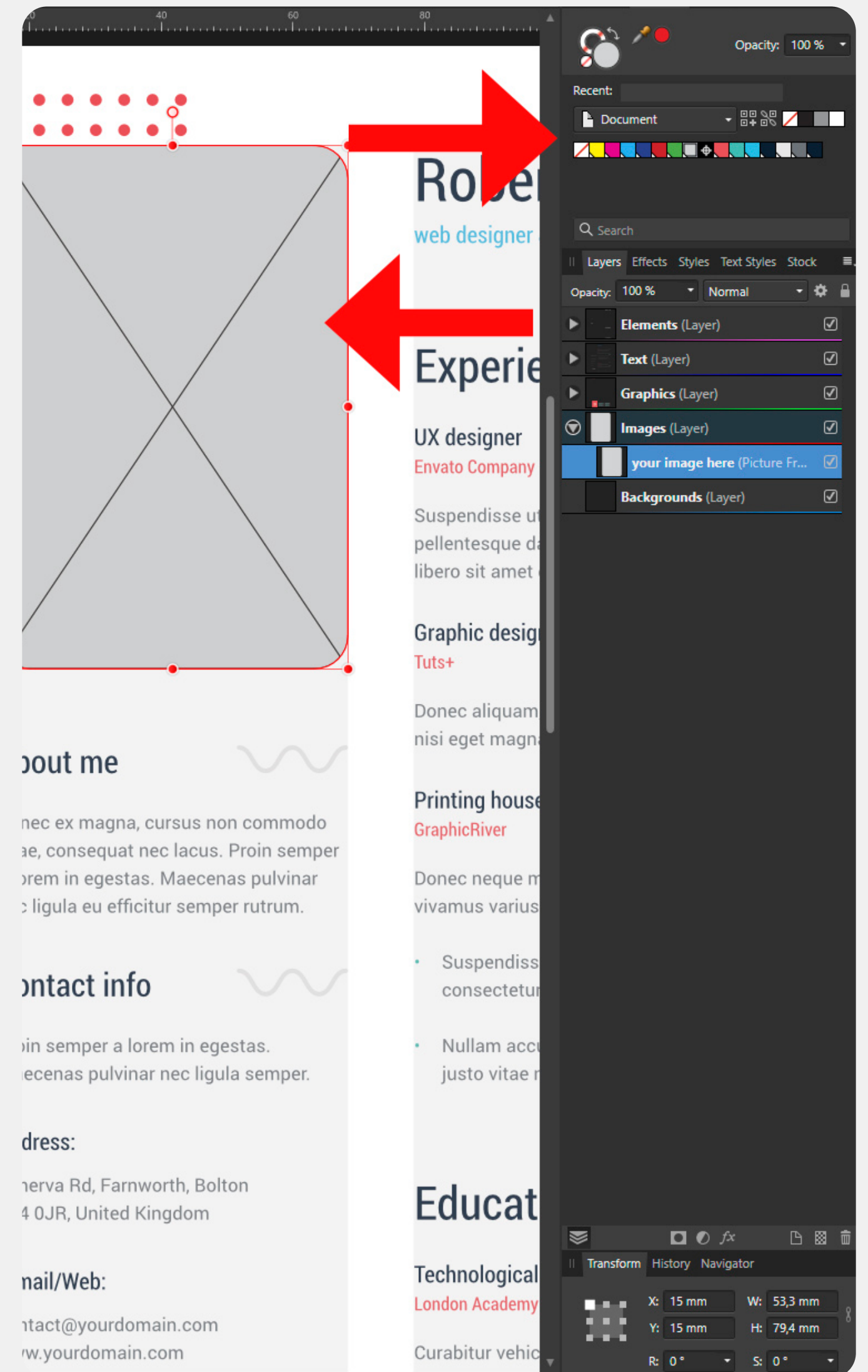

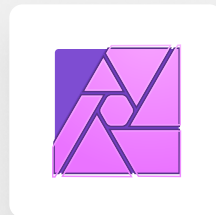

Affinity Photo

Change text

To edit the text, **double click on the layer with the text in the "Layers" panel** and type or paste the text that suits you.

Add your image

Double-click on the gray rectangle "**your image here**". A new window will open where you can place your photo by **dragging it** into the program. Then save the file (**Ctrl + S**) and close the window. **Go back** to the previous view.

Color template

Select the single item you want to change or select several similar items. For example, select section **titles by pressing Shift and clicking** the mouse on individual elements. From the "**color**" panel, select any that interests you.

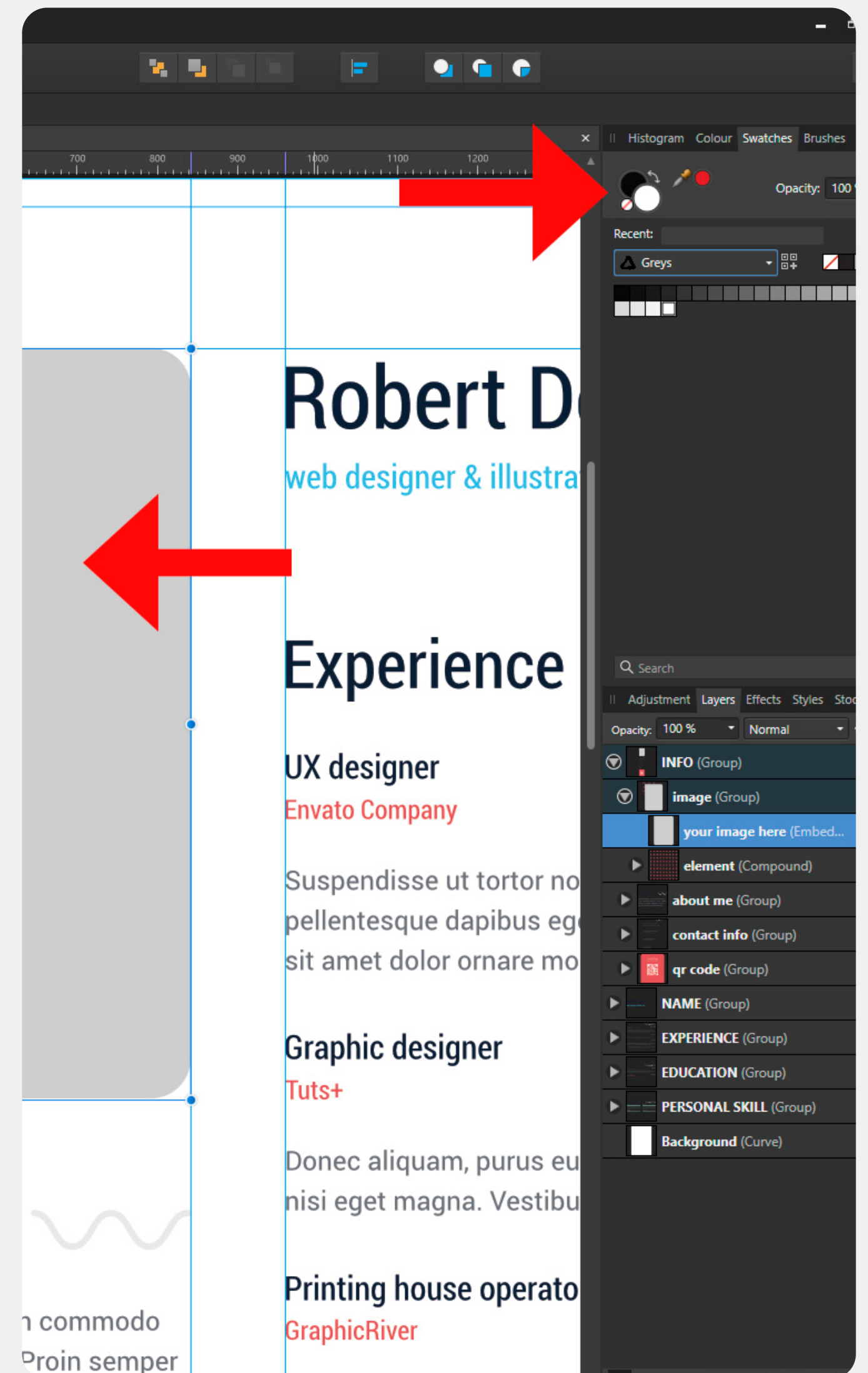

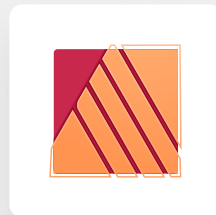

Affinity Publisher

Change text

To edit the text, **double-click on the text field** you want to edit and type or paste the text that suits you.

Add your image

Select the gray rectangle that says "**your image here**".

Drag the image into the rectangle or choose **File - Place (Ctrl + Shift + M)** and select your photo. Adjust the photo to the size of the rectangle.

Color template

In the "**Swatches**" tab, select the "**Document**" colors and then you can freely edit the entire layout by **clicking on a particular tile / color**.

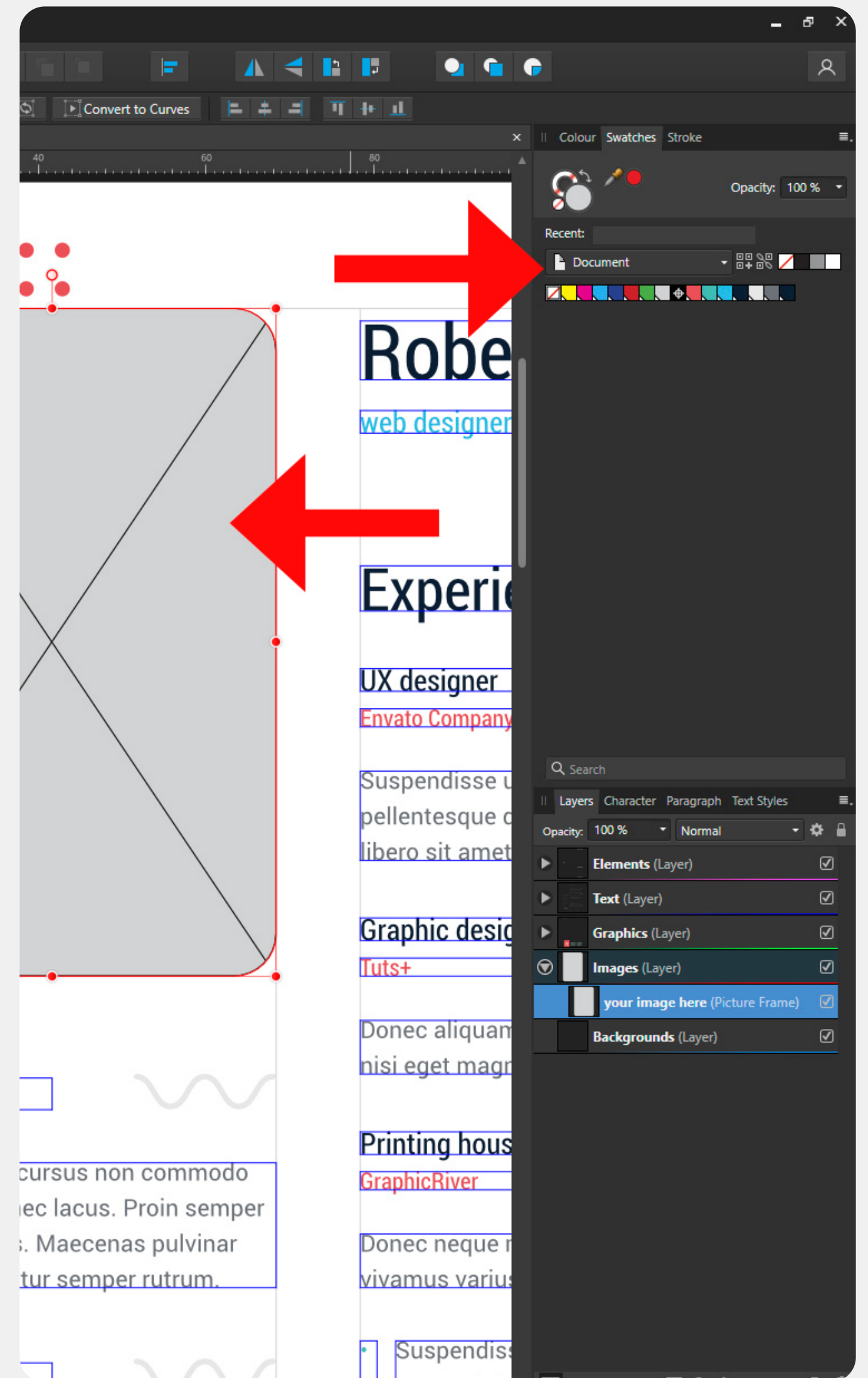

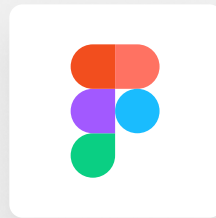

Figma

Change text

To edit the text, **double-click on the text field** you want to edit and type or paste the text that suits you.

Add your image

Select the gray "**your image here**" rectangle. Select the gray circle from the "**Fill**" panel, and then select the "**Image**" drop-down list. Choose your photo that you can fit into a rectangle or crop.

Color template

In the "**Swatches**" tab, select the "**Document**" colors and then you can freely edit the entire layout by **clicking on a particular tile / color**.

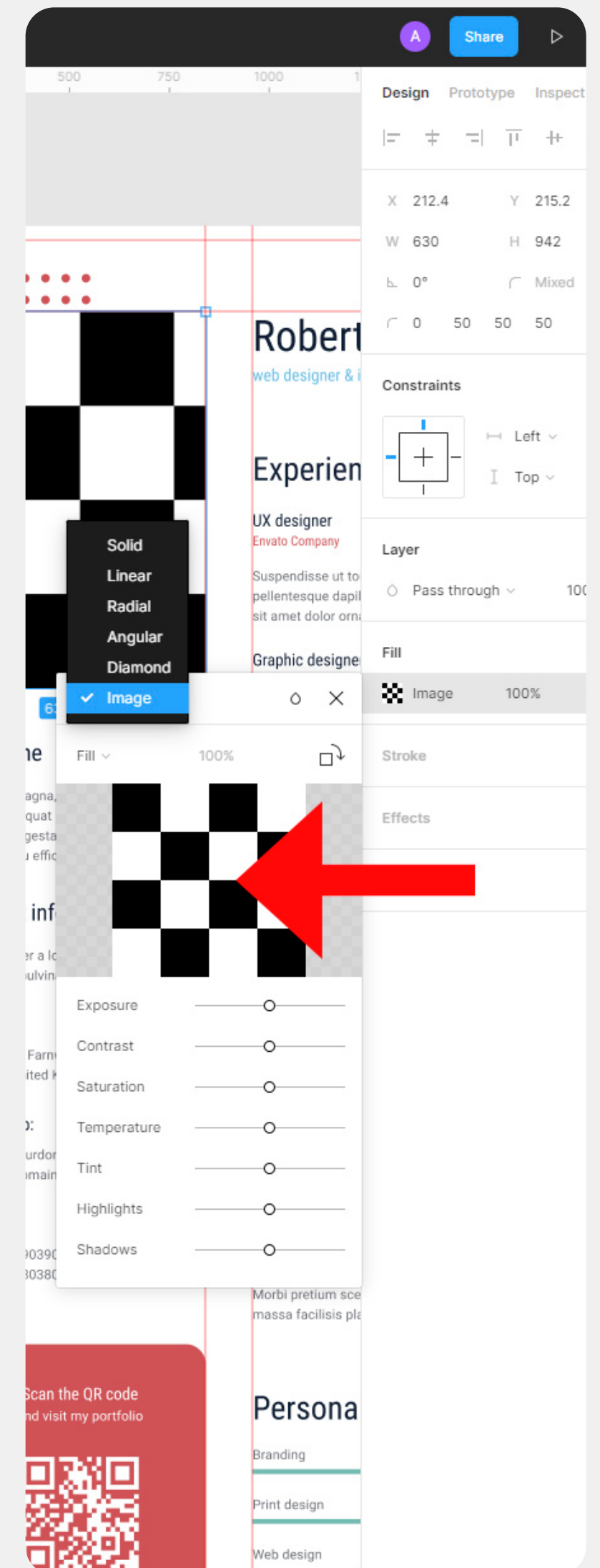
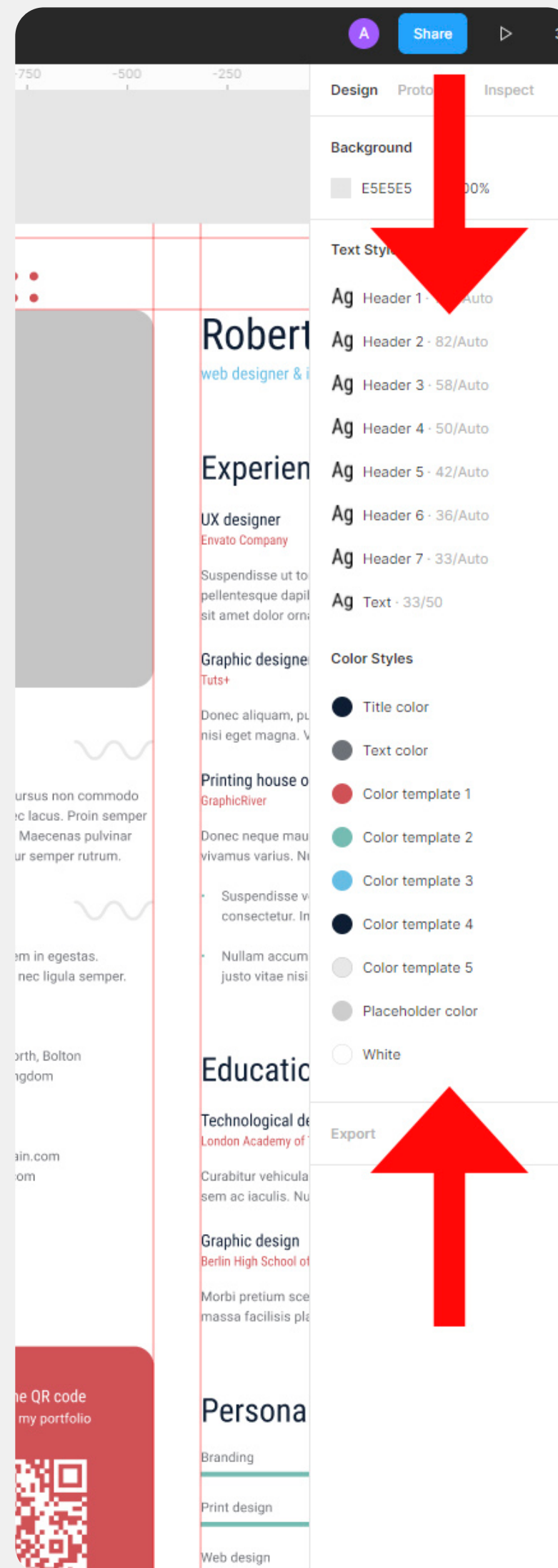



Microsoft Word

Change text

To edit the text, **double-click on the text field** you want to edit and type or paste the text that suits you.

Add your image

Right click on the gray rectangle "**your image here**" and then select "**format shape**". A window will appear on the right where you select "**Image or texture fill**". Select a photo from your computer.

Color template

If you want to change the color of the template, in the upper part of the screen, select the "**Design**" tab, and then "**Color**". There will be an additional option for the **Dark version**, but you can also use the suggestions in this section.

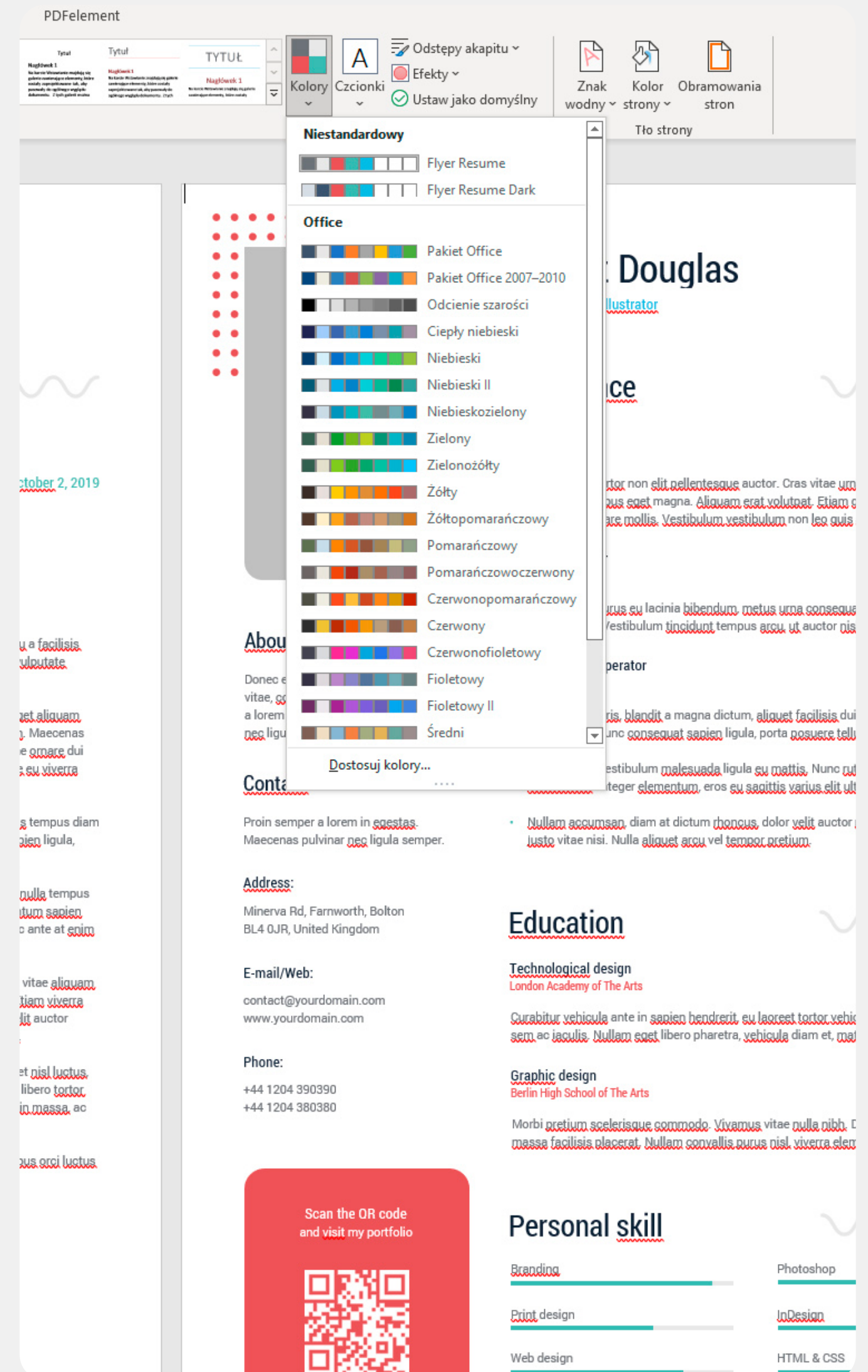

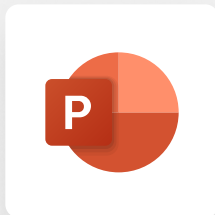

Microsoft PowerPoint

Change text

To edit the text, **double-click on the text field** you want to edit and type or paste the text that suits you.

Add your image

Drag your photo from the computer to the marked placeholder "image here". If you want to edit the image, you can use the tools on the **top bar** of the screen to **crop** or **adjust the image**.

Color template

You can change the colors of a theme to the light or dark version that are included in the template, but also use the default that the layout contains. You can create your own color sets in the **"View"** tab and then **"Master template"**, **"Colors"**, **"Customize colors"**.

