

BASIC SETTINGS AND RECOMMENDATIONS :

1. Use the RGB Mode and 8 Bits color
2. Use English versions of Photoshop
3. Be sure the photo set Background from layer (Go to Layer/New/Background from layer)
4. Set the Opacity brush and flow to 100%
5. Best use photo sizes between 2000–3000px

HOW TO INSTALL ACTIONS :

1. Click Alt+F9 to open action panel

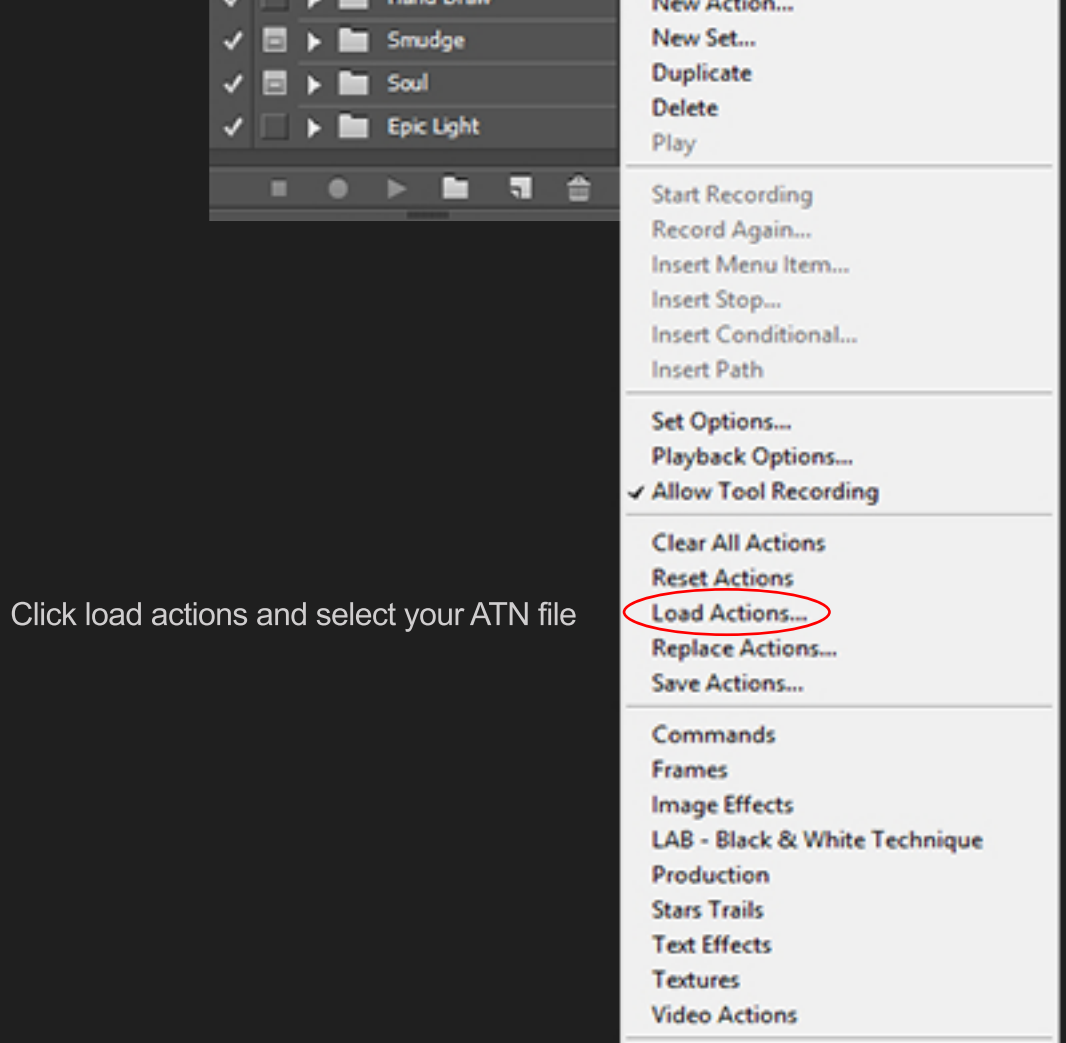

HOW TO INSTALL BRUSH AND PATTERNS :

1. Click Edit/Presets/Presets Manager

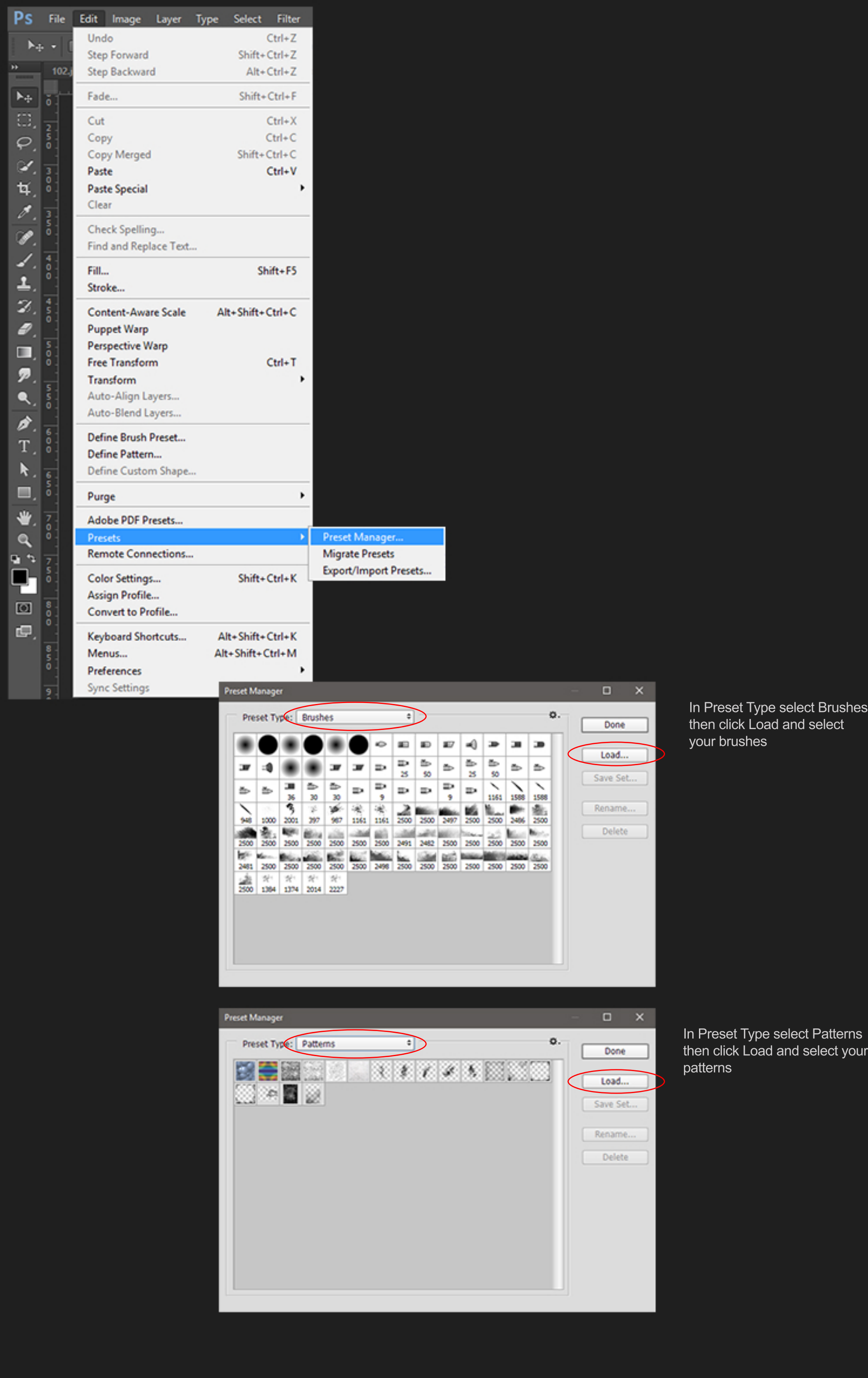

HOW TO PLACE PHOTO AND CREATE SUBJECT LAYER :

1. Open your photo and be sure Background is locked (Layer/New/Background from layer)

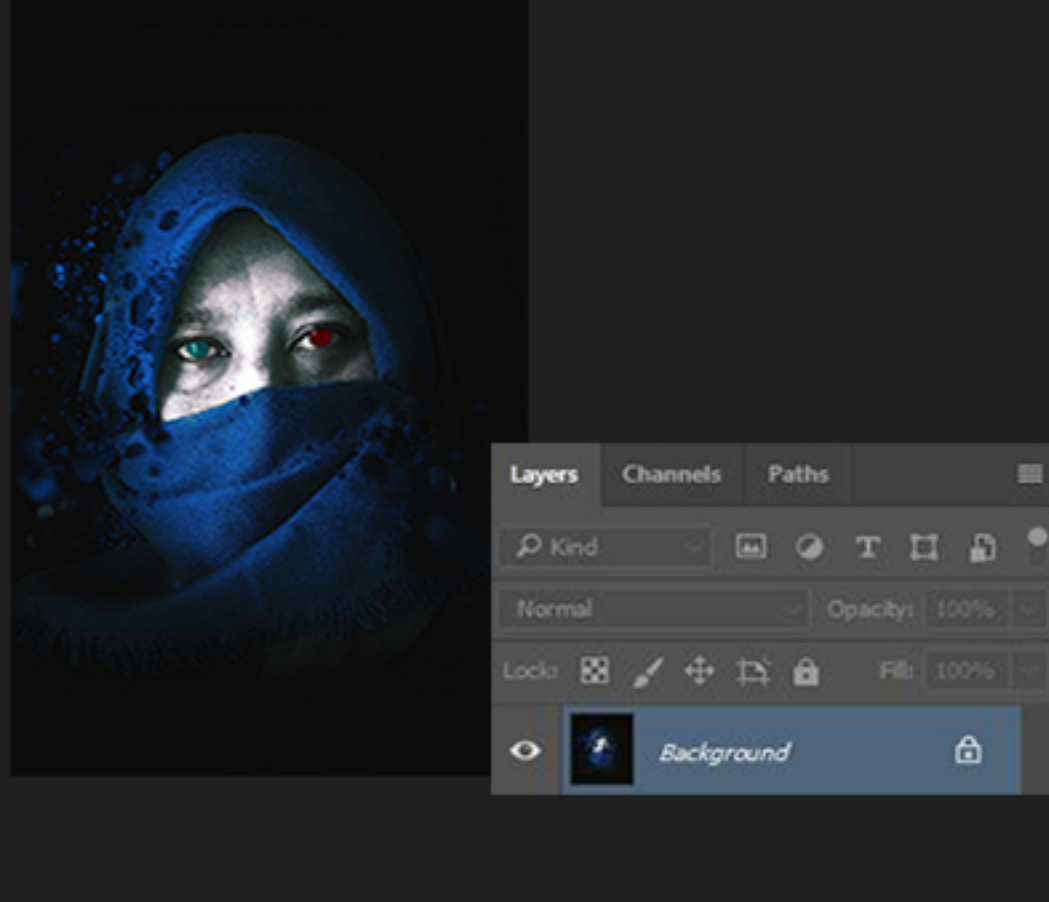

2. Create new layer, place your text or logo and name this layer **subject** (all smallcaps without space)
3. Select **subject** layer and play Static_Photo action

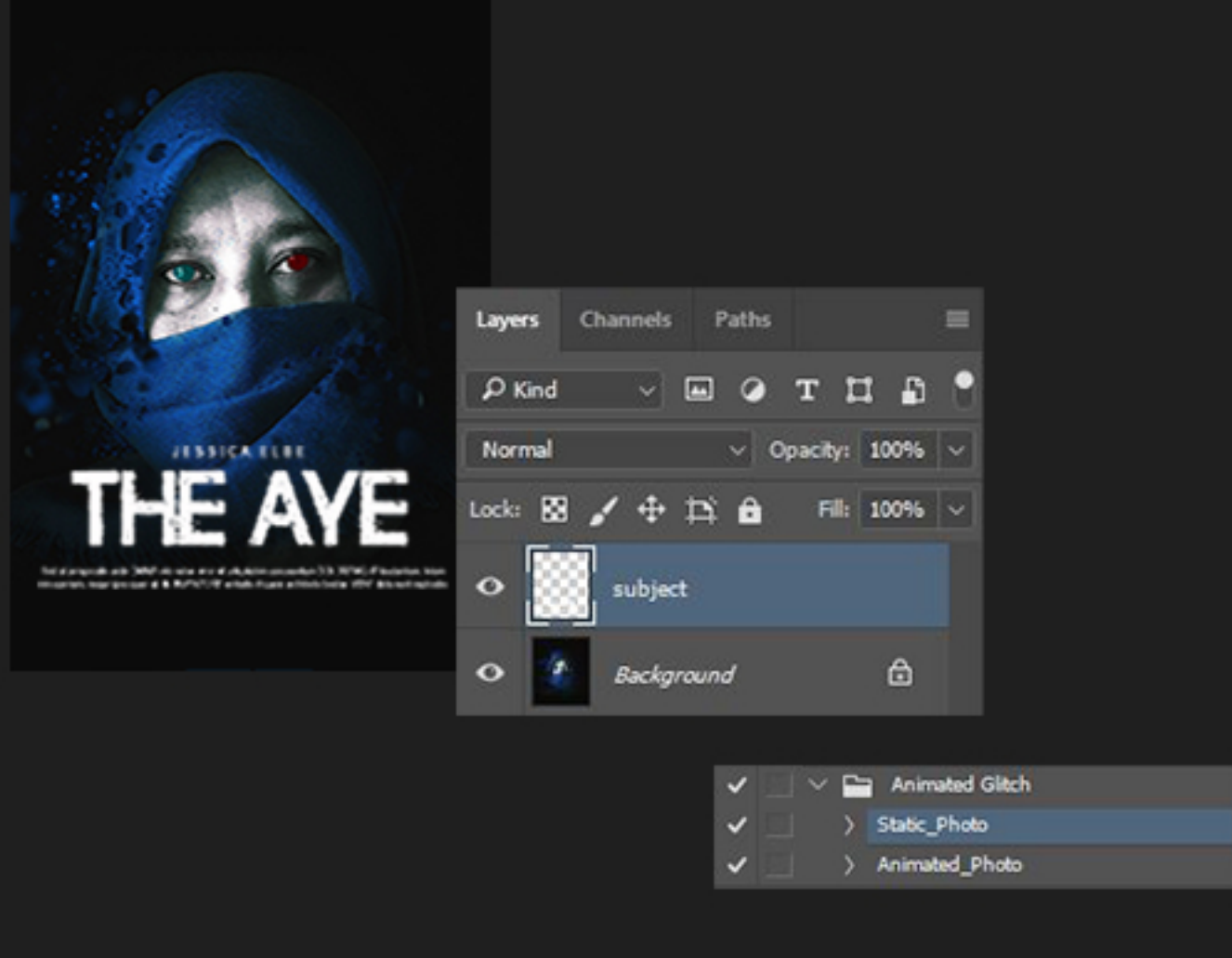

4. After action finished your layer looks like this, watch video tutorial how to play with layers for better use :
- Save as JPG for static image

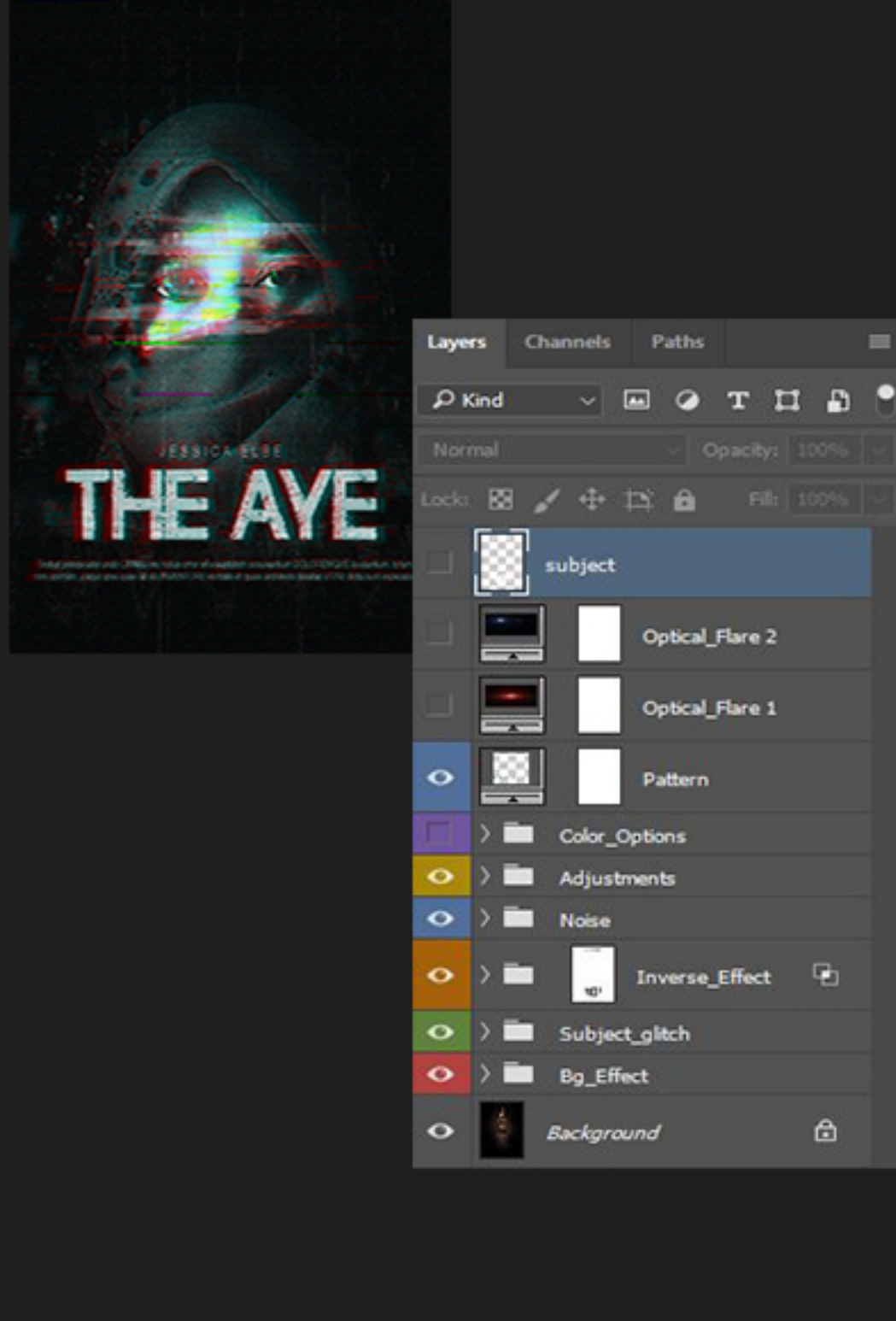

5. Open Timeline for animation Window/Timeline and play Animated_Photo action

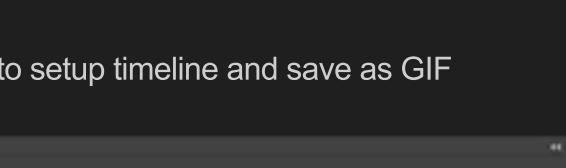

After action finished your timeline looks like this, watch video tutorial how to setup timeline and save as GIF

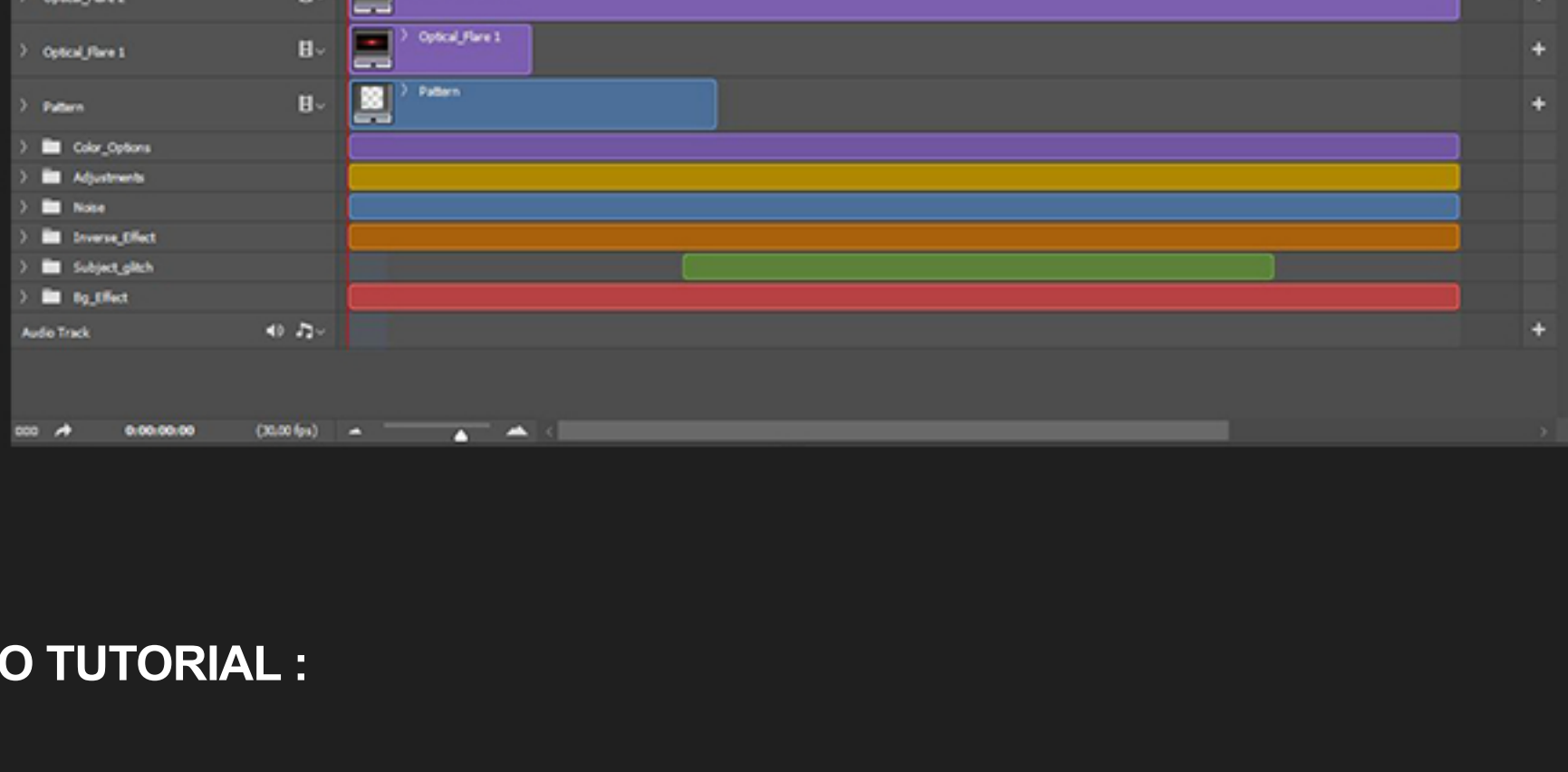

VIDEO TUTORIAL :

For better use action please watch video tutorial on my YouTube channel

https://www.youtube.com/watch?v=_8LbUp2U-0

How to basic settings Photoshop for play action

<https://www.youtube.com/watch?v=Dd0Go0v01Ns>

FOR MORE ITEMS CHECK : <https://graphicriver.net/user/dgas99/portfolio?ref=dgas99>